



SUNWAVE

User Manual **SUNWAVE**



For LINSUM LSMi series micro inverter product
V1.0

OVERVIEW INTRODUCTION

Sunwave Cloud is an internet-based platform which enables you to monitor and configure energy systems and to visualize system data on both web browsers and smart phone applications.

In order to use Sunwave Cloud, you will need a Linsum product that is capable of recording your system data and sending it to Sunwave Cloud.

*Depending on the Linsum product that sends the data, availability of functions and features may vary on Sunwave Cloud.

You can log into SunwaveCloud website at <https://www.sunwave.cloud/login>.

Sunwave Cloud smartphone application is available on the Google Play Store or the Apple App Store. You can also scan the QR codes below to download the app to your smartphone devices.



CATALOGUE

GETTING STARTED..... 02

1. APP USER GUIDANCE 03

1.1 Sign up and Log in 03
1.2 Creating a System 04
1.3 Operating the System 05
1.4 User Management 09

2. WEB USER GUIDANCE 12

2.1 Sign up and Log in 12
2.2 Creating a System 14
2.3 Operating the System 15
2.4 User Management 19

GETTING STARTED

- **Requirements**

A smart end device (e.g. laptop, tablet, PC, smartphone) must be available.

Active internet connection must be established on this smart end device.

1. APP USER GUIDANCE

• 1.1 Sign up and Log in

▲ Sign up as a new user on SUNWAVE APP

Procedure

1. In your smartphone open the SUNWAVE APP
2. Select **Sign up**.
3. Fill in necessary information such as Country/Region, etc.
4. Enter a valid email address. Click Send.
In the next few minutes, you will receive an e-mail containing a Verification Code.
If you have not received any e-mail from Sunwave Cloud, check whether the e-mail has been sorted to junk mail, or an incorrect e-mail address was entered.
5. Fill in the necessary information for signing up.
6. Select Sign Up at the bottom of the list.
7. Upon successful registration, Sunwave Cloud will redirect you to the Log in page.
8. Enter the e-mail address and Sunwave Cloud password in the fields Account and Password.
word.
9. Click Login.

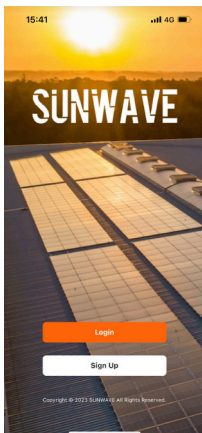

Figure 1. App Welcome

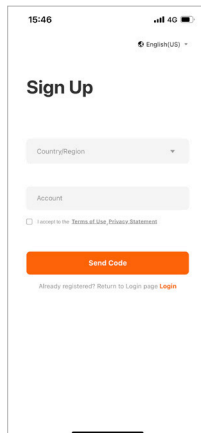

Figure 2. Sign Up

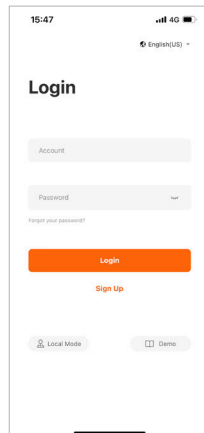

Figure 3. Login

▲ Log in to SUNWAVE APP as an existing user

Procedure

1. Open SUNWAVE APP.
2. Enter the e-mail address and password in the fields Account and Password.
3. Click Log In.

● 1.2 Creating a System

▲ Sign up as a new user on SUNWAVE APP

Notice

In order to be able to monitor and configure your devices, you need to create a system on Sunwave Cloud and add your devices to the system.

*The properties entered when creating the system can be changed at any time in system settings.

Procedure

1. Log in Sunwave APP.
2. Select the menu tab System List at bottom of the page in app.
3. Click the button  icon in top right corner of the page in app.
4. Fill in the necessary information for creating the system.
5. Select **Complete**.

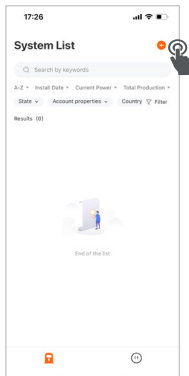

Figure 4. System List



Figure 5. Adding New System

● 1.3 Operating the System

Adding and Removing Devices

If you already have a system created in SUNWAVE APP, you can add new devices to the system, or remove existing devices from the system.

Notice

The Serial Number (SN) and Identification Key (KEY) of the label, or the QR code of the label of the Linsum communication product must be available.

Adding a Communication Device

You can add communication devices (e.g. Wireless dongles, Microinverter) to an existing system. After successfully adding of the device to the system, the device will be displayed within the system's device list.

*If a communication device is already added to an existing system, you cannot add it to another system without removing the device from its current system.

*Depending on the type of communication device, configuring internet connection of the device to SunwaveCloud via a router may be required.

Procedure

1. Log into SUNWAVE APP.
2. Select the system menu.
3. Select the system.
4. On the top right corner call up the System menu.
5. Select Add device.
 - 1) The Find Device interface opens.

Sunwave Cloud requires access to camera to add your devices by scanning the QR code on the label of your device.
 - 2) Scan the QR code of the device, which registers the SN and KEY of this device, in order to add it to the system.

You can also add device by Bluetooth.
 - 3) Click Internet Connection to select and connect the available WIFI.
 - 4) Tap Add to System
6. Upon successful registering of the device to the system, Sunwave Cloud will return to the Inverters page.

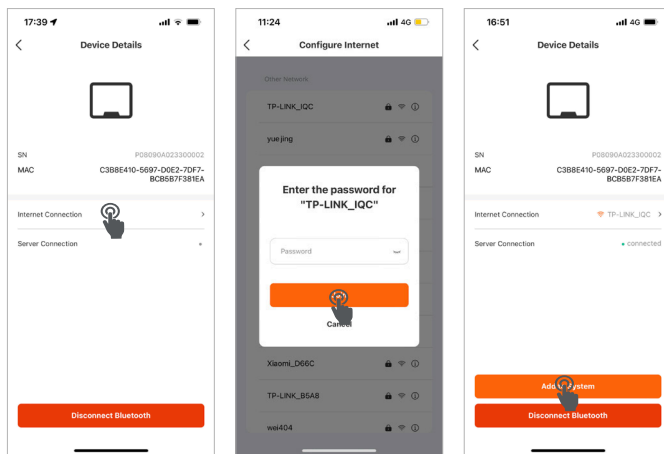
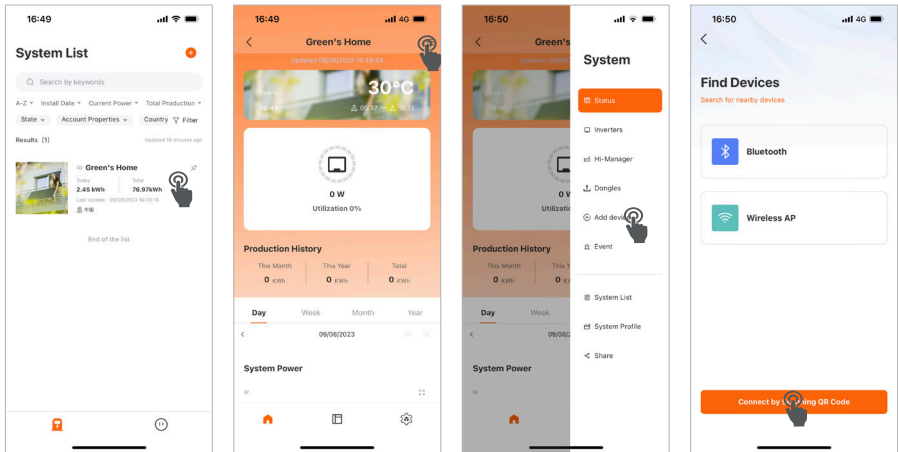

Figure 6. APP Adding a Communication Device

Removing a Device

Communication devices can be removed from the system. The removed device can be re-added to the previous system, or it can be added to a new system.

Procedure

On the tab of the device, swipe left. Remove your device from the list by selecting **Unbind Device**.

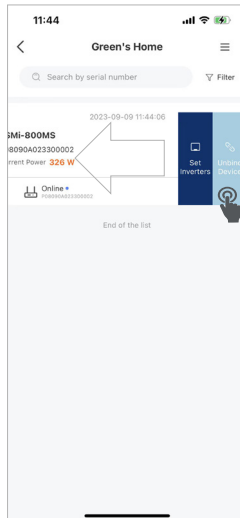

Figure 7. App Unbind a Communication Device

*Historical data of the removed device will be visible within the original system's historical data section.

Configuring Internet

Notice

- Internet must be available to the communication device.
- Active internet connection must be established on this smart end device.
- The communication device must be powered.

Procedure

1. Log in SUNWAVE APP.
2. Select the system.
3. On the top right corner, select the menu.
The System menu opens from the right side of screen.
4. Select Inverters, turn to inverter list page.
5. Tap the inverter that you want to configure turn to Inverter Status page.
6. On the top right corner, open the menu and select Configure Internet; or enter the Local Mode at the login interface.
The Find Devices interface opens.
7. Connect device
 - Sunwave APP requires Access to camera to connect your devices by scanning the QR code on the label of your device.
 - Scan the QR code of the device, which registers the SN and KEY of this device.
 - You can also connect device by Bluetooth.
8. Select Internet Connection.
The internet configuration page opens.
Your smart device searches for all wireless networks within its range.
9. Select your network and enter its password.

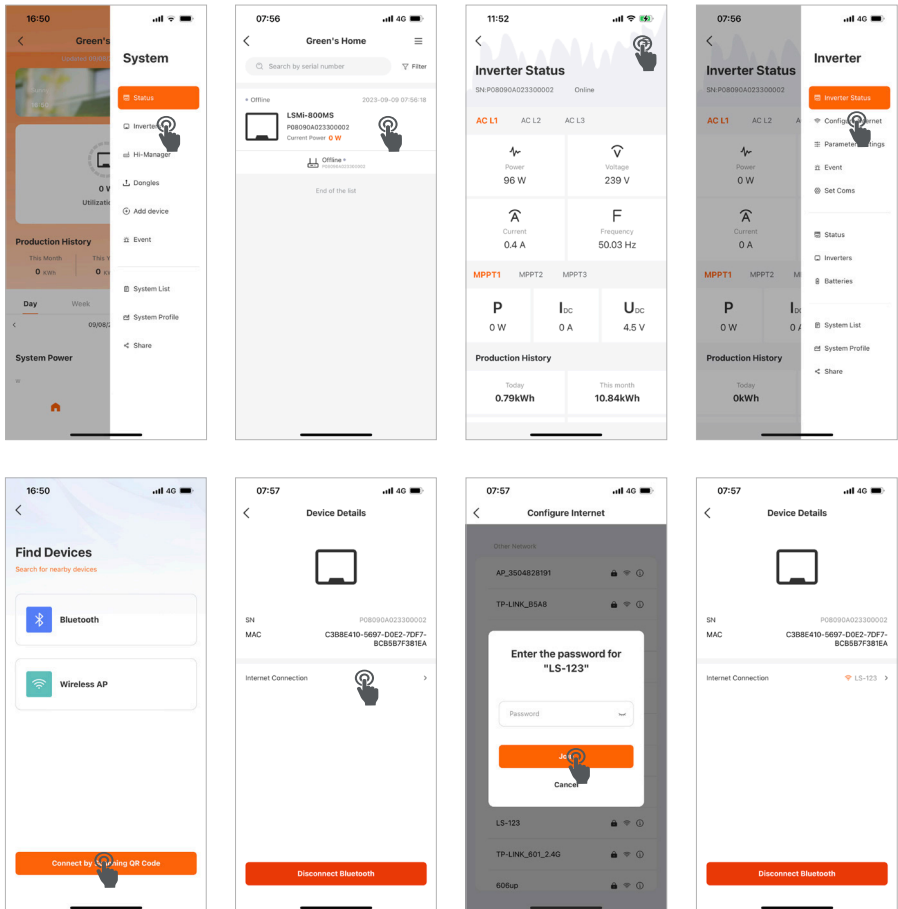

Figure 8. Configuring Internet

● 1.4 User management

Adding and Removing Users

If you already have an account created in Sunwave Cloud, you can add other account as your subordinate users or parent users for easier management.

Adding Subordinate Users

- If you are a wholesaler or installer, you may need to help the user install and diagnose inverters by adding subordinate users as installers or end-users, you can access to all their system and inverters.
- If you are an owner of power system, you may want to share your system's basic information with your family/friends or have a professional staff to operate the system for you. By adding subordinate users as visitors or admin, you can share your systems' overview or administrative permissions.

Procedure

1. Log in SUNWAVE APP.
2. Select the right tab and turn to setting page.
3. Select Account.
4. Tap  .
5. Enter Target subordinate username.
6. Select OK.

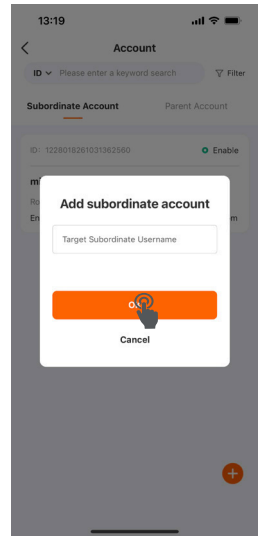
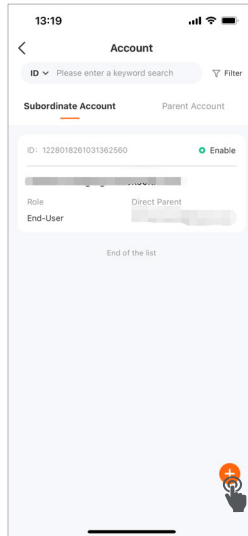
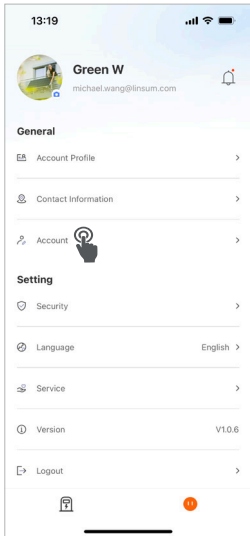

Figure 9. APP Adding a User

Manage subordinate users

Procedure

1. Log in to SUNWAVE APP.
2. Select the right tab and turn to setting page.
3. Select Account.
4. Swipe left and you can perform operations on the user

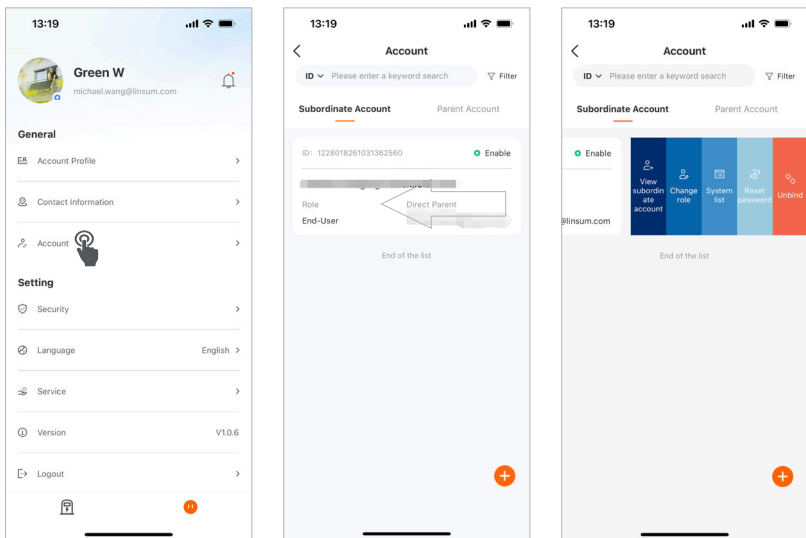

Figure 10. Manage Subordinate User

Follow operations are provided:

- View subordinate account
- Change role
- View system list
- Reset subordinate password
- Unbind

2. WEB USER GUIDANCE

● 2.1 Sign up and Log in

▲ Sign up as a new user on <https://www.sunwave.cloud/login>

Procedure

1. In your web browser open site <https://www.sunwave.cloud/login>
2. Select **Sign up**.
3. Select Account type
4. Enter a valid email address. Click Send.
In the next few minutes, you will receive an e-mail containing a Verification Code.
If you have not received any e-mail from SunwaveCloud, check whether the e-mail has been sorted to junk mail, or an incorrect e-mail address was entered.
5. Fill in the necessary information for signing up.
6. Select Sign Up at the bottom of the page.
7. Upon successful registration, Sunwave Cloud will redirect you to the Log in page.
8. Enter the e-mail address and Sunwave Cloud password in the fields Account and Password.
9. Click Log In.

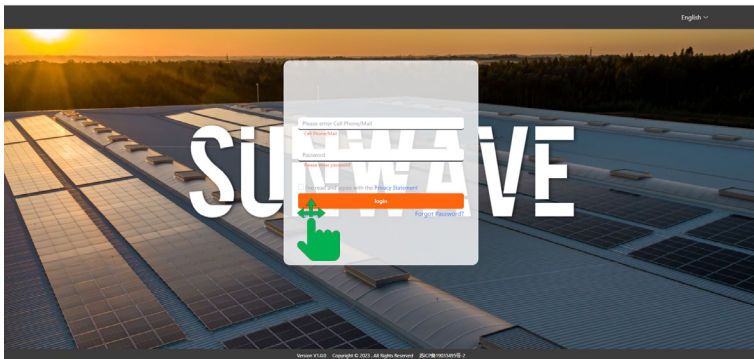

Figure 11. Sign UP on Web

▲ Log in to SUNWAVE cloud web as an existing user

Procedure

1. Open site <https://www.sunwave.cloud/login>
2. Enter the e-mail address and password in the fields Account and Password.
3. Click Log In.

● 2.2 Creating a System

Notice

In order to be able to monitor and configure your devices, you need to create a system on Sunwave Cloud and add your devices to the system.

*The properties entered when creating the system can be changed at any time in system settings.

Procedure

1. Log in [www.https://www.sunwave.cloud/login](https://www.sunwave.cloud/login)
2. Select the menu tab System at the top of the page.
3. Click  at top right corner of the page. Fill in the necessary information for creating the system.
4. Confirm the owner of the system, and add user roles if it's required.
5. Select **Complete**.

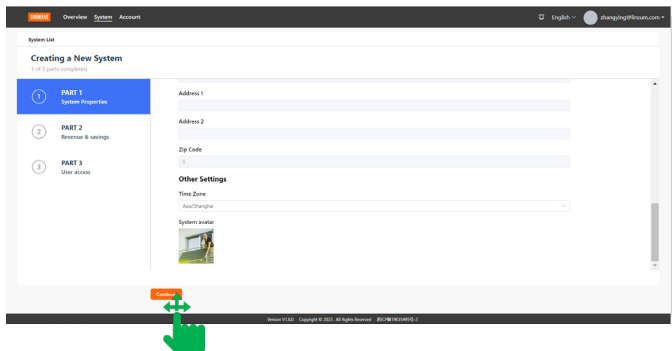
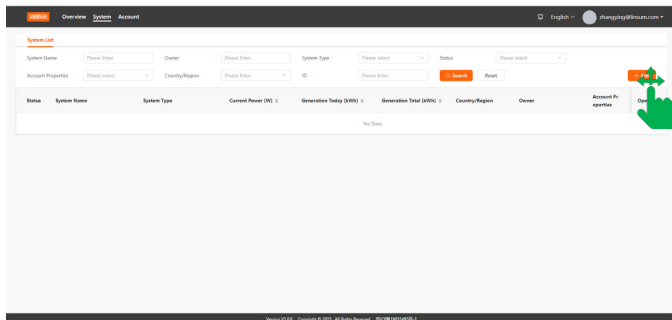

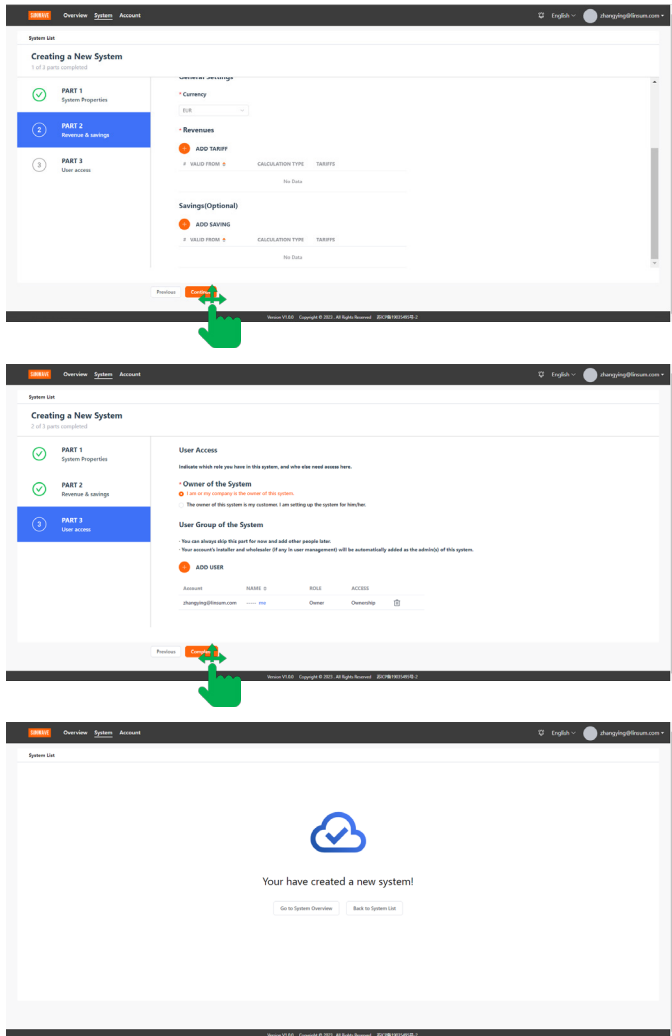

Figure 12. Creating a System

● 2.3 Operating the System

Adding and Removing Devices

If you already have a system created, you can add new devices to the system, or remove existing devices from the system.

Notice

The Serial Number (SN) and Identification Key (KEY) of the label, or the QR code of the label of the Linsum communication product must be available.

Adding a Communication Device

You can add communication devices (e.g. Wireless dongles, Microinverter) to an existing system. After successfully adding of the device to the system, the device will be displayed within the system's device list.

*If a communication device is already added to an existing system, you cannot add it to another system without removing the device from its current system.

*Depending on the type of communication device, configuring internet connection of the device to SunwaveCloud via a router may be required.

Procedure

1. Log in [www.https://www.sunwave.cloud/login](https://www.sunwave.cloud/login)
2. Select the System menu.
3. Select Device menu.
4. Select  Add Device.
5. Entering its SN and KEY which could be found on the label of the device.
6. After successful registering of the device to the system, SunwaveCloud will return to the Device page.

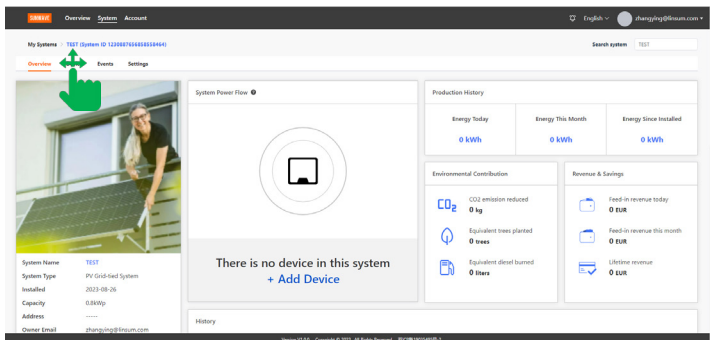

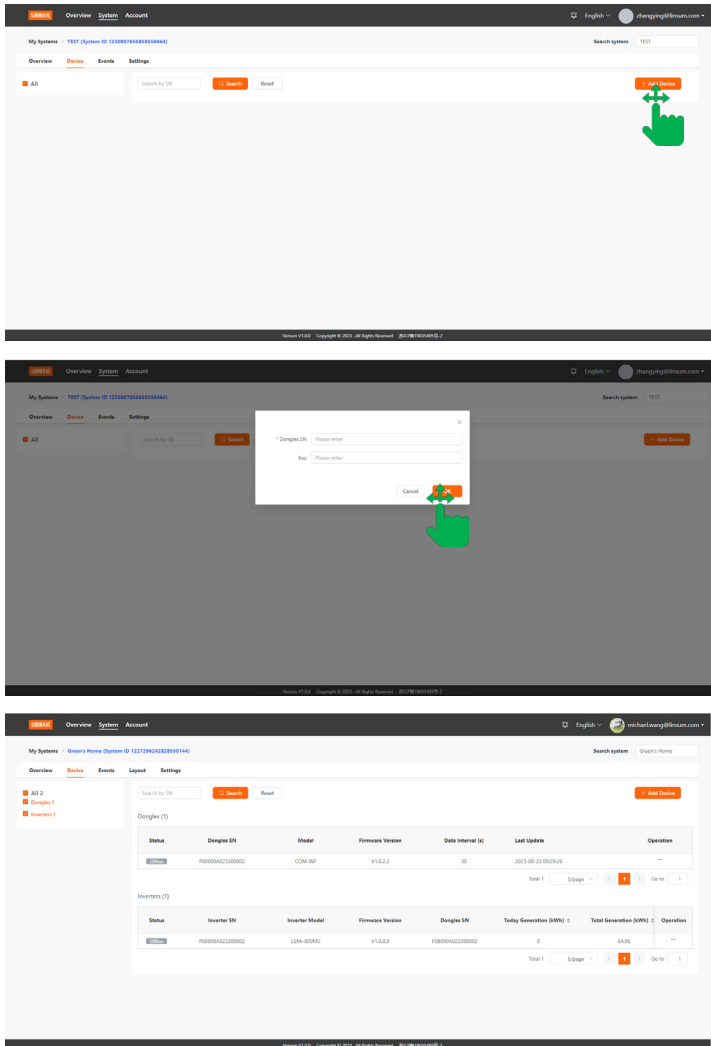

Figure 13. Adding a Communication Device

Removing a Device

Communication devices can be removed from the system. The removed device can be re-added to the previous system, or it can be added to a new system.

Procedure

In the Dongles list, open the Operation menu, remove your device from the list by selecting **Unbind Device**.

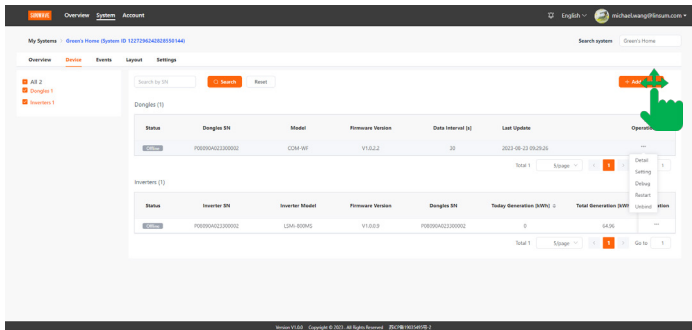

Figure 14. Removing a Device

*Historical data of the removed device will be visible within the original system's historical data section.

Configuring Internet

Follow Above chapter 1. APP User Guidance -> 3) Operating the System-> Configuring Internet

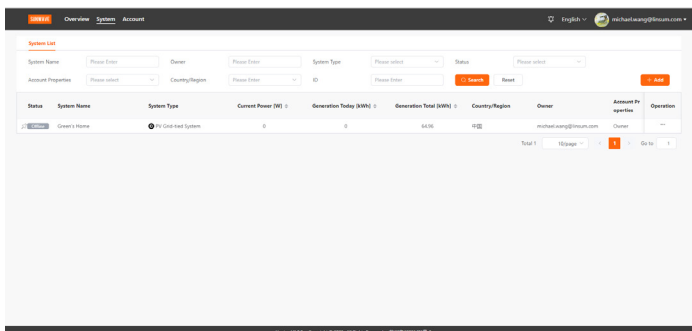

Figure 15. Configuring Internet

● 2.4 User management

Adding and Removing Devices

If you already have an account created in Sunwave Cloud, you can add other account as your subordinate users for easier management.

Adding Subordinate Users

If you are an installer, you may need to help the user install and diagnose inverters by adding subordinate users as end-users, you can access to all their system and inverters.

Figure 16. Account type Selection (when sign up)

Procedure

1. Log in <https://www.sunwave.cloud/login>
2. Select Account menu.
3. Select Add User.
4. Select Add User.
5. Enter E-mail, Password & select Target Role.
6. Select OK.

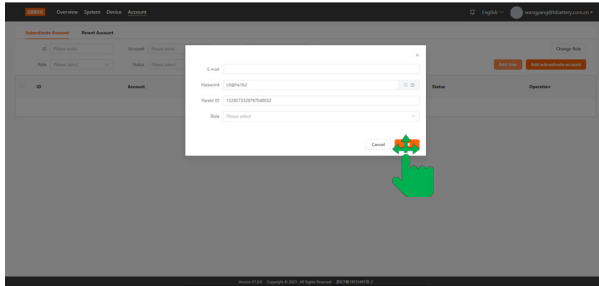

Figure 17. Adding Subordinate Users

Managing subordinate users

Procedure

1. Log in <https://www.sunwave.cloud/login>
2. Select Account.
3. Select Operation to manage a subordinate user.

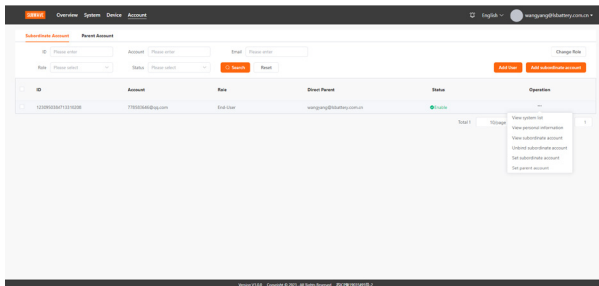
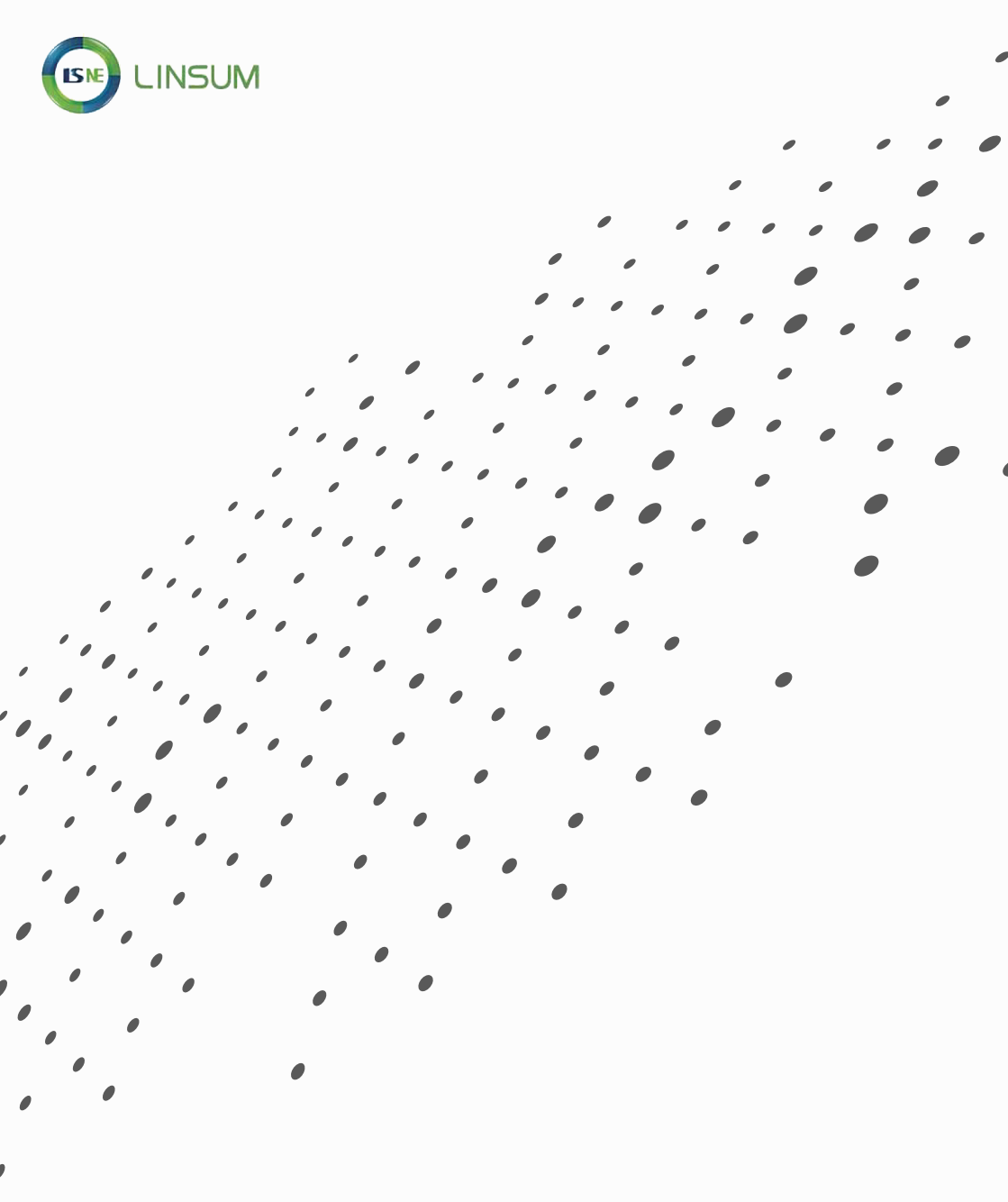

Figure 18. Managing Subordinate Users



LINSUM CO.,LTD. (HEADQUATER)

No.8 Chengwan Road, Suzhou Industrial Park, 215122 Suzhou, China
Enquiry email: info@linsum.com
Service email: service@linsum.com
Contact tel: +86 512 62818366

LINSUM GMBH (EU COMPANY)

Hildesheimer Strasse 265 - 267, 30519 Hannover, Germany
Enquiry email: info@linsum.de
Service email: service@linsum.de
Contact tel: +49-511-87592457